

B2.NO.P4.VA ▶

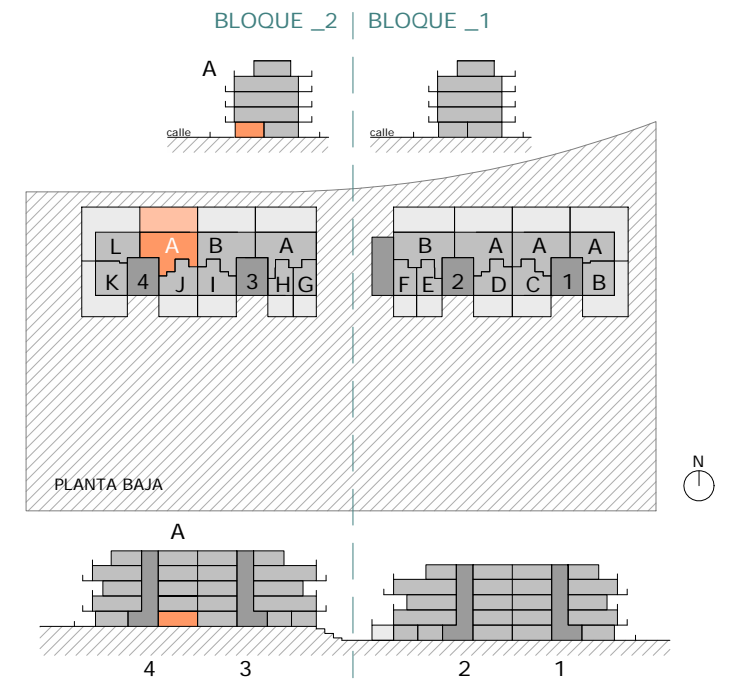
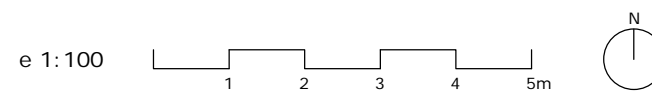

SUPERFICIES ÚTILES

Salon-comedor-cocina	30,88 m ²
Dormitorio-2	9,49 m ²
Dormitorio-1	12,63 m ²
Baño-2	3,71 m ²
Baño-1	4,02 m ²
TOTAL SUP. ÚTIL INTERIOR	60,74 m²
Patio	53,74 m ²
TOTAL SUP. ÚTIL EXTERIOR	53,74 m²
TOTAL SUP. ÚTIL	114,48 m²

SUPERFICIES CONSTRUIDAS

Vivienda	72,17 m ²
% Comunes	13,03 m ² (1,62 %)
TOTAL	85,19 m²
Patio	56,99 m ²
TOTAL SUP. CONSTRUIDA	142,18 m²



VIVIENDA A - PLANTA BAJA

PORTAL 4 - bloque 2

[2 DORMITORIOS]